

410 W 207

I N W O O D



RARE OPPORTUNITY
IN NEW YORK'S
NEXT EMERGING
NEIGHBORHOOD





RETAIL |



- 100' from the 1 Subway train
- Directly adjacent to MTA bus stop
- On-site Parking
- Customized for cooking use with access to kitchen exhaust or louvers for precipitators

- Double-height Storefronts with up to 18' ceilings
- Direct access to storage space on the lower level
- Residential building above will include 700 units
- Surrounding buildings will bring an additional 1,000 units online in 2025

RETAIL

FLOOR PLANS



2,062 SF

2,017 SF

834 SF

4,521 SF

1,651 SF

1,254 SF

1,328 SF



WEST 27TH STREET



MARKET |



- 16,400 SF Corner Market
- 5,100 SF of lower level storage space with direct access through an elevator
- Customized for market use and led through the NYC FRESH program
- Direct loading through a dedicated dock on 206th Street
- On-Site Parking
- Large signage opportunities with amazing vehicular and pedestrian traffic on 207th Street at the foot of the 207th Street Bridge

410 W 207
IN WOOD

MARKET

FLOOR PLAN

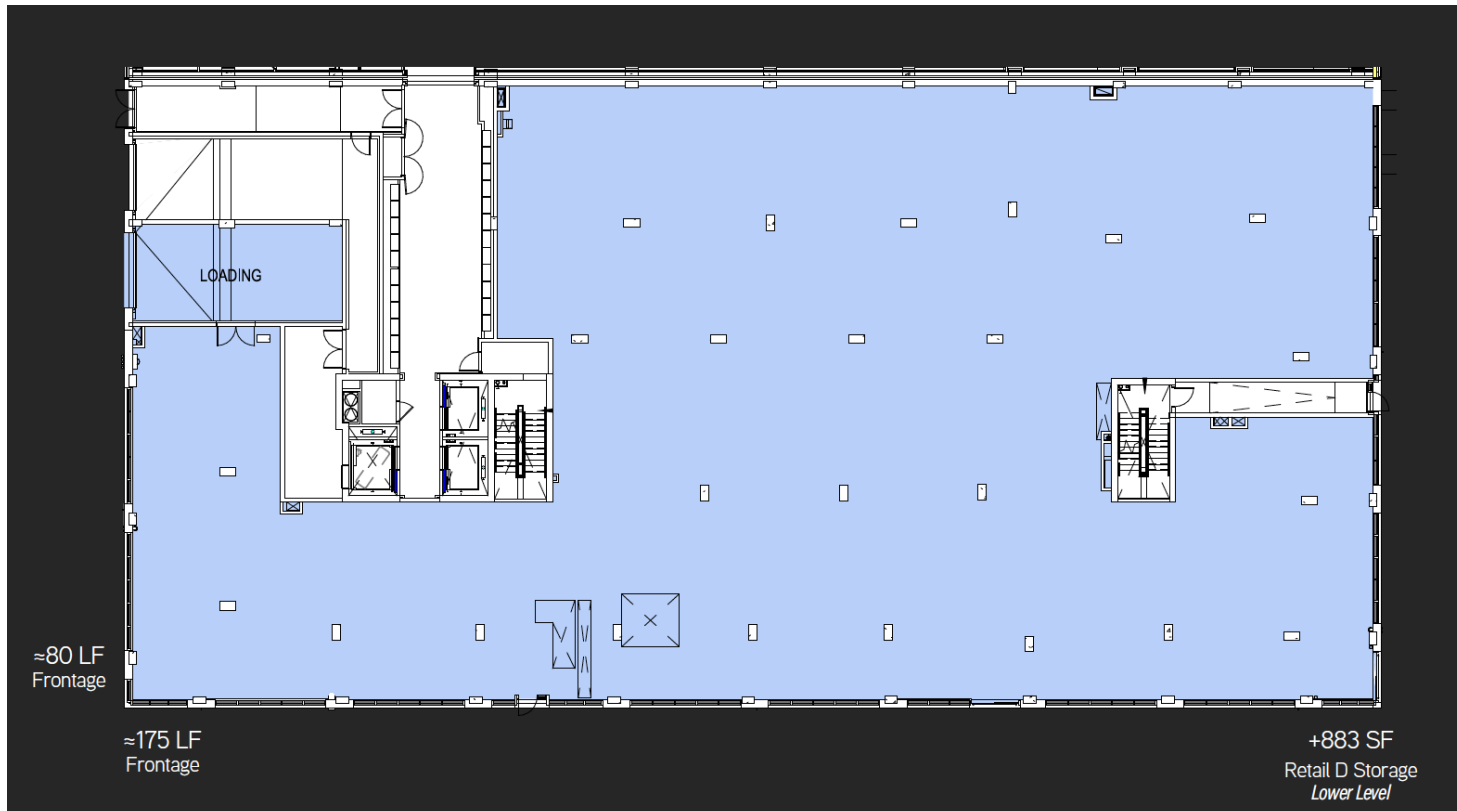

NEIGHBORHOOD |

INWOOD
HILL
PARK

410 W 207 INWOOD

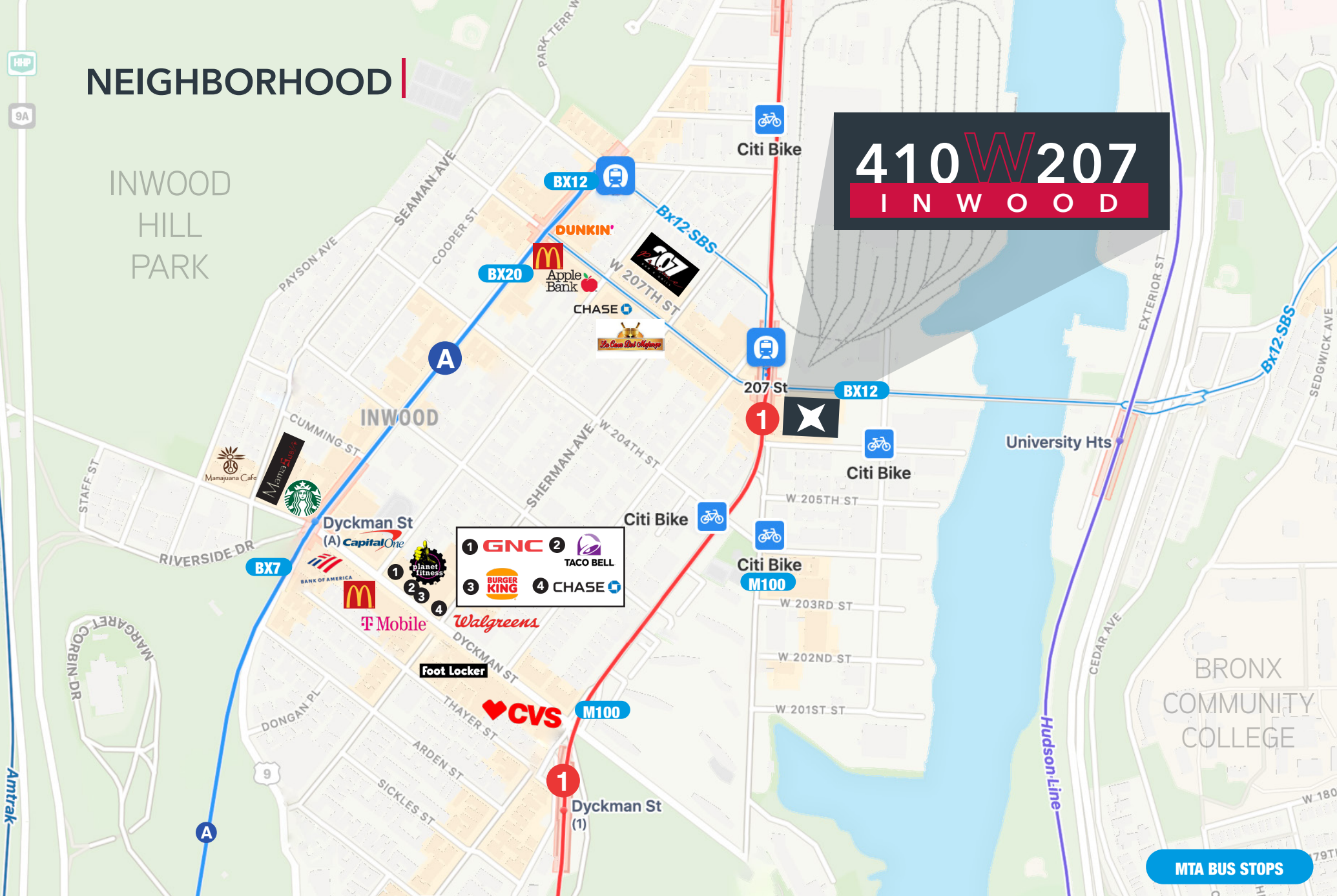

410 W 207 INWOOD

410 W 207

IN WOOD

FOR MORE INFORMATION, PLEASE CONTACT:

PETER BRAUS
MANAGING PRINCIPAL
212.776.1203
pbraus@lee-associates.com

STEVE LORENZO
PRINCIPAL
845.629.1640
slorenzo@lee-associates.com

JEFFREY LOPEZ
DIRECTOR
646.284.4047
jlopez@lee-associates.com

MANUEL JIMENEZ
ASSOCIATE
917.853.9583
mjimenez@lee-associates.com

