

964 AMSTERDAM AVENUE

BETWEEN 107TH & 108TH STREETS

FOR LEASE

LEE & ASSOCIATES
COMMERCIAL REAL ESTATE SERVICES



SPACE INFORMATION

SPACE A **413 sf**

SPACE B **475 sf**

SPACE C **443 sf**

AVAILABLE

SPACE D **407 sf**

Frontage 10' per space

Rent Upon Request

Possession Immediate

Comments

- Just south of Columbia University
- Only Space D remains
- Vented
- Bathroom
- HVAC installed
- Close to the **1** subway line

FOR MORE INFORMATION, PLEASE CONTACT:

BRAD SCHWARZ

Executive Managing Director and Principal
212.776.1290
bschwarz@lee-associates.com

UEMGEE 'OLIVIA' HWANG

Senior Managing Director
212.776.1238
ohwang@lee-associates.com

All information supplied is from sources deemed reliable and is furnished subject to errors, omissions, modifications, removal of the listing for sale or lease, and to any listing conditions, including the rates and manner of payment of commissions for particular offerings imposed by principals or agreed by this Company, the terms of which are available to principals or duly licensed brokers. Any square footage dimensions set forth are approximate.

964 AMSTERDAM AVENUE

BETWEEN 107TH & 108TH STREETS

FOR LEASE

LEE & ASSOCIATES
COMMERCIAL REAL ESTATE SERVICES

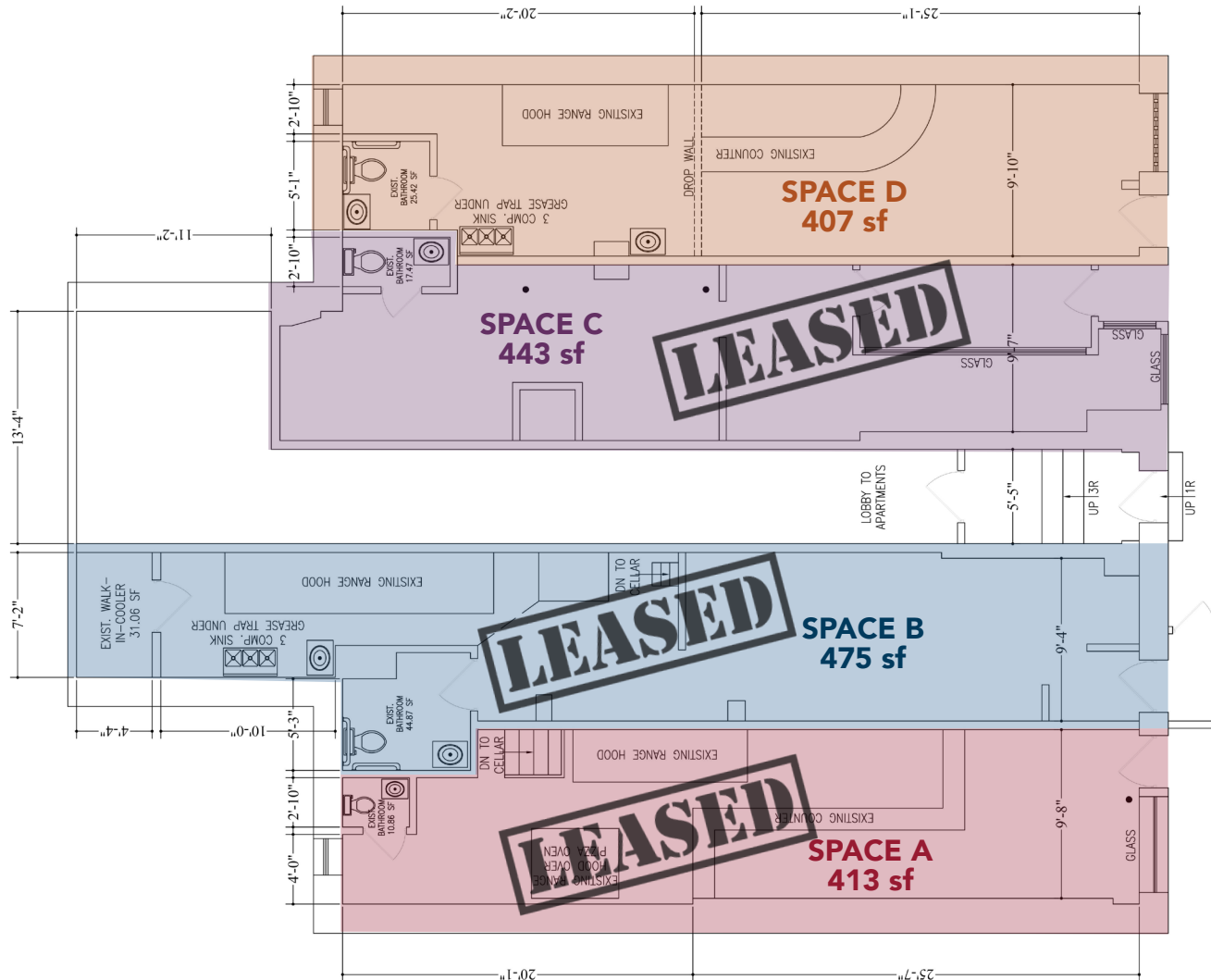

FOR MORE INFORMATION, PLEASE CONTACT:

BRAD SCHWARZ

Executive Managing Director and Principal
212.776.1290
bschwarz@lee-associates.com

UEMGEE 'OLIVIA' HWANG

Senior Managing Director
212.776.1238
ohwang@lee-associates.com

All information supplied is from sources deemed reliable and is furnished subject to errors, omissions, modifications, removal of the listing for sale or lease, and to any listing conditions, including the rates and manner of payment of commissions for particular offerings imposed by principals or agreed by this Company, the terms of which are available to principals or duly licensed brokers. Any square footage dimensions set forth are approximate.

964 AMSTERDAM AVENUE

BETWEEN 107TH & 108TH STREETS

FOR LEASE

LEE & ASSOCIATES
COMMERCIAL REAL ESTATE SERVICES



NEIGHBORS



FOR MORE INFORMATION, PLEASE CONTACT:

BRAD SCHWARZ

Executive Managing Director and Principal
212.776.1290
bschwarz@lee-associates.com

UEMGEE 'OLIVIA' HWANG

Senior Managing Director
212.776.1238
ohwang@lee-associates.com

All information supplied is from sources deemed reliable and is furnished subject to errors, omissions, modifications, removal of the listing for sale or lease, and to any listing conditions, including the rates and manner of payment of commissions for particular offerings imposed by principals or agreed by this Company, the terms of which are available to principals or duly licensed brokers. Any square footage dimensions set forth are approximate.