



# Historic **FRONT STREET**

Turnkey  
dry cleaner  
space

EXCLUSIVE LEASING AGENTS

**JP SUTRO**

Executive Managing Director  
212.776.1274  
jsutro@lee-associates.com

**BRAD SCHWARZ**

Principal  
212.776.1290  
bschwarz@lee-associates.com

**PETER BRAUS**

Managing Principal  
212.776.1203  
pbraus@lee-associates.com

**221  
FRONT  
STREET**

Between Peck Slip and Beekman Street



# LOWER MANHATTAN

Historic

## SOUTH STREET SEAPORT

# FRONT STREET

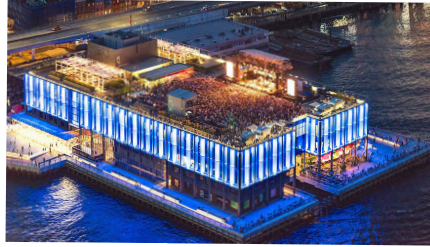

Jean-Georges  
(The Fulton)  
40,000 SF

PIER 17

EAST RIVER

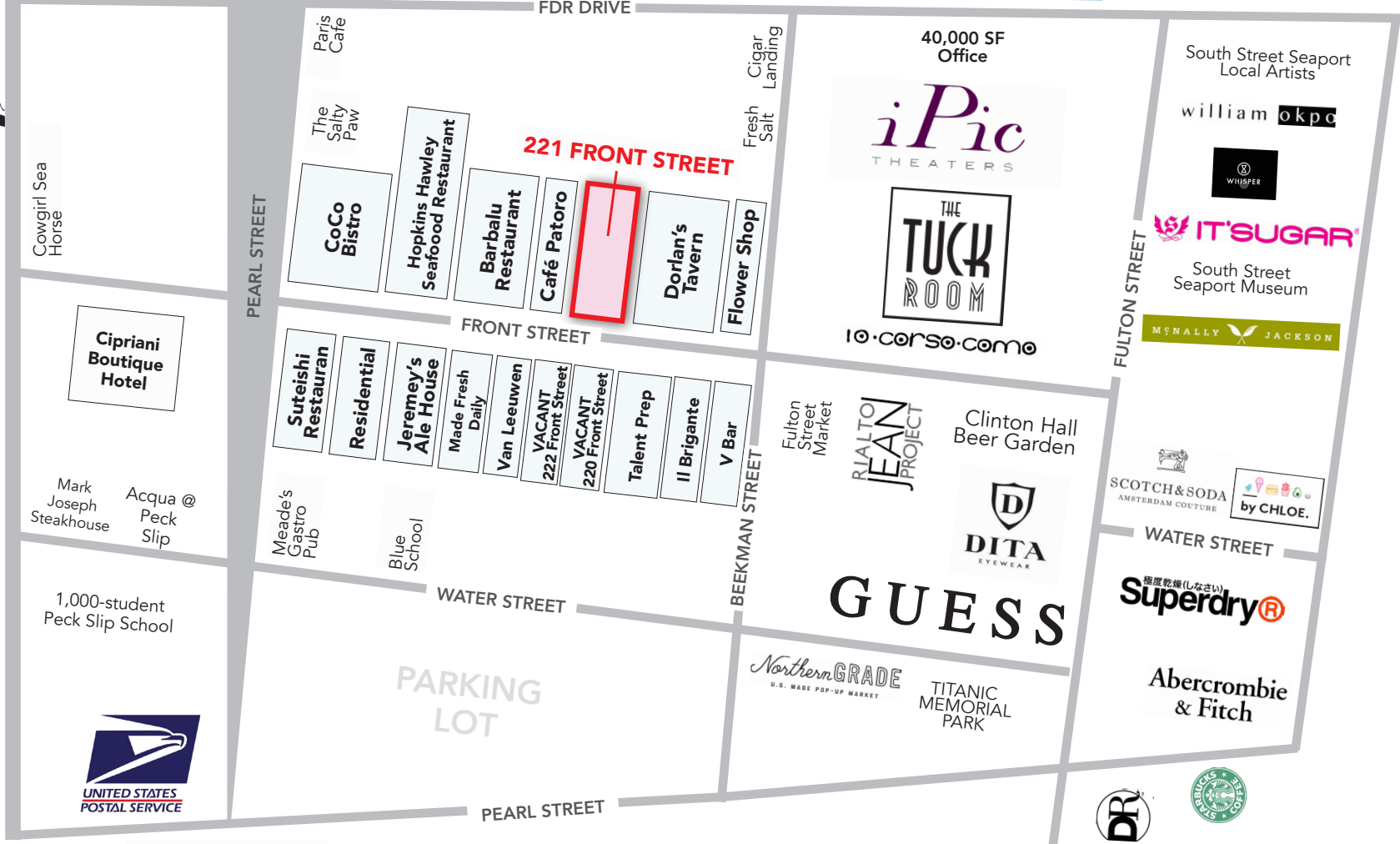

# DOWNTOWN MARKET STATS

## SOUTH STREET SEAPORT

Only minutes from Wall Street, TriBeCa, Battery Park, City Hall and the NYSE.

### TOURISTS



Annually  
**15 MILLION**

### SPENDING



Annually  
**\$33 BILLION**

  
NYC ATTRACTIONS  
**RANKED TOP**  
**5**

# Historic FRONT STREET



TRAVEL+LEISURE RANK  
**26**  
AMONG MOST VISITED  
SITES IN THE WORLD



### LOWER MANHATTAN

**Residential Units:**  
30,000 currently exist  
+5,900 additional units  
under construction

**Residents:**  
87,000

**Average Household Income:**  
\$206,000

**Hotel Rooms:**  
11,589

### WORKFORCE

**Employed:**  
310,000

**Firms:**  
8,500

**Annual Transit  
Riders**  
127 Million

**Office Space**  
84 MSF

EXCLUSIVE LEASING AGENTS

**JP SUTRO**  
Executive Managing Director  
212.776.1274  
jsutro@lee-associates.com

**BRAD SCHWARZ**  
Principal  
212.776.1290  
bschwarz@lee-associates.com

**PETER BRAUS**  
Managing Principal  
212.776.1203  
pbraus@lee-associates.com



# 221 FRONT STREET

## SPECIFICATIONS

### SPACE

600 SF

### FRONTAGE

12'

### CEILING

13'

### RENT

Upon Request

### POSSESSION

Immediate

\* All measurements are approximate

### COMMENTS

- Turnkey dry cleaner installation (formerly Aphrodite Cleaner)
- All-glass façade
- ADA-compliant

### NEIGHBORS

- Pier 17 - 6 restaurants, rooftop concert venue, ESPN production studio
- Jean-George Fish Market
- Mr. C Seaport (Cipriani Luxury Hotel)
- Scotch & Soda
- IPIC Theater
- Van Leeuwen

# Historic FRONT STREET

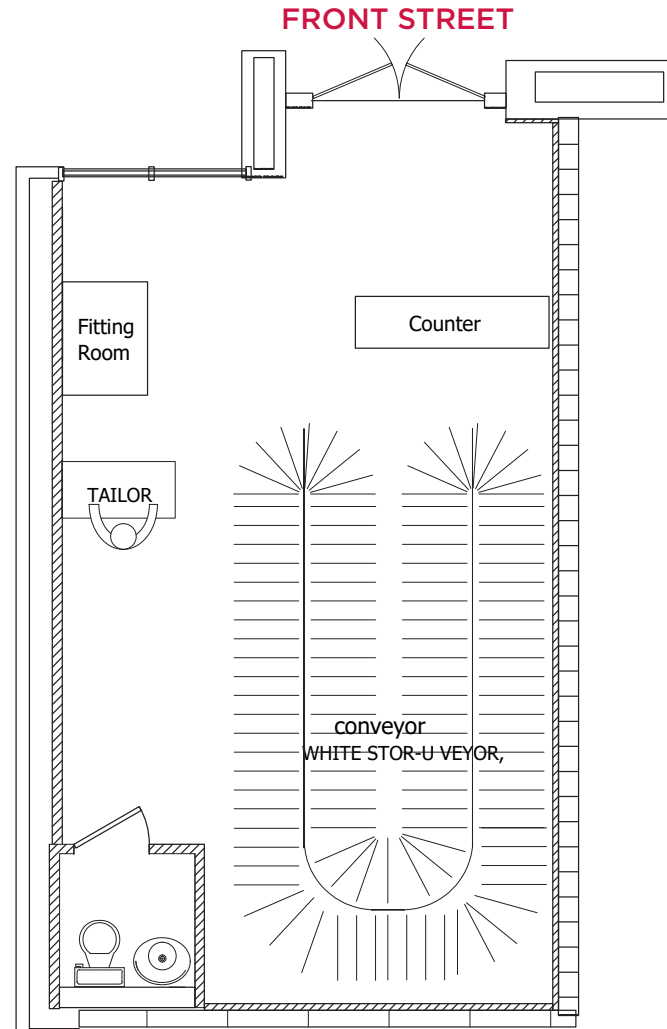

EXCLUSIVE LEASING AGENTS

**JP SUTRO**

Executive Managing Director  
212.776.1274  
jsutro@lee-associates.com

**BRAD SCHWARZ**

Principal  
212.776.1290  
bschwarz@lee-associates.com

**PETER BRAUS**

Managing Principal  
212.776.1203  
pbraus@lee-associates.com