

As exclusive leasing agents, we are pleased to offer the following prime space for lease:

162-164-166 BLEECKER STREET

BETWEEN SULLIVAN STREET & THOMPSON STREET



PRIME GREENWICH VILLAGE RETAIL

FOR MORE INFORMATION CONTACT

Mark Kapnick
Executive Managing Director & Principal
mkapnick@lee-associates.com
212.776.1230

Morris Dweck
Director
mdweck@lee-associates.com
212.776.1246

As exclusive leasing agents, we are pleased to offer the following prime space for lease:

162-164-166 BLEECKER STREET

BETWEEN SULLIVAN STREET & THOMPSON STREET

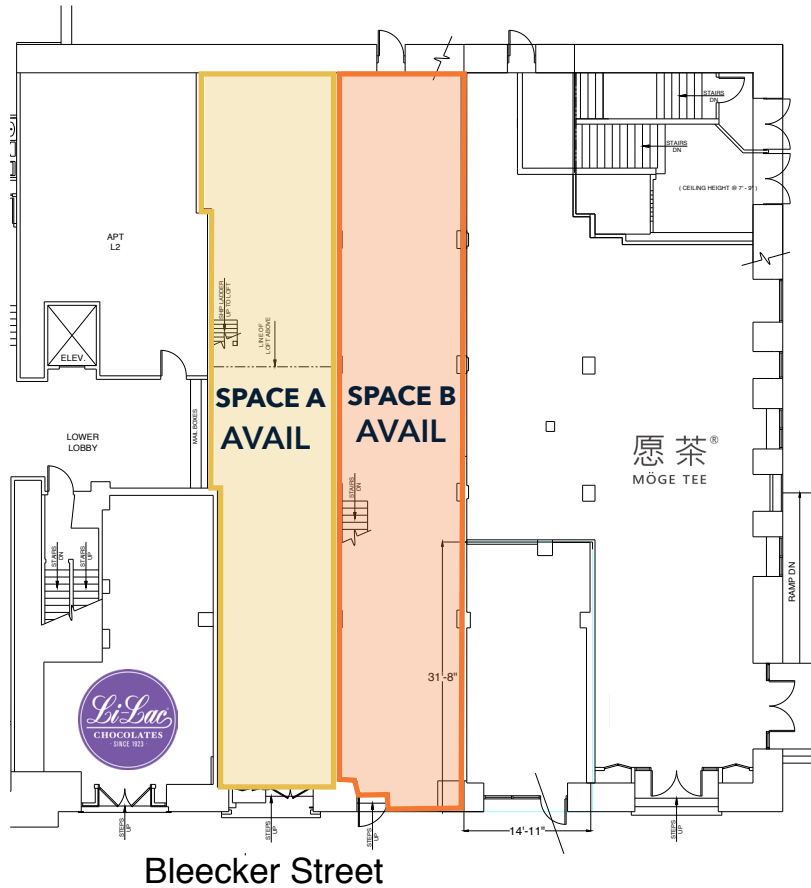

Sullivan Street

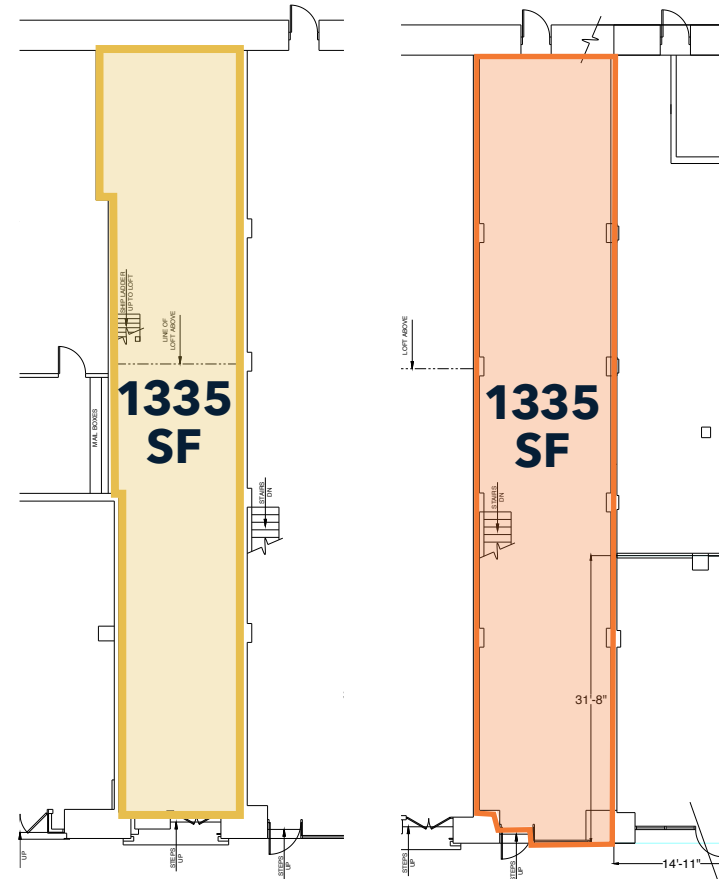

SPACE A | B
 Ground Floor **1335 SF**
 Frontage **12'**
 Ceiling Height **16'**
 Asking Rent **Upon Request**
 Possession **Immediate**

NEIGHBORS

COMMENTS

All Uses Considered
 Newly renovated ground floor retail
 Heavy daytime & evening population

Gas: Yes
 200 Amp Electric
 Plumbing: Yes
 Venting: Brand New Type 1

As exclusive leasing agents, we are pleased to offer the following prime space for lease:

162-164-166 BLEECKER STREET

BETWEEN SULLIVAN STREET & THOMPSON STREET

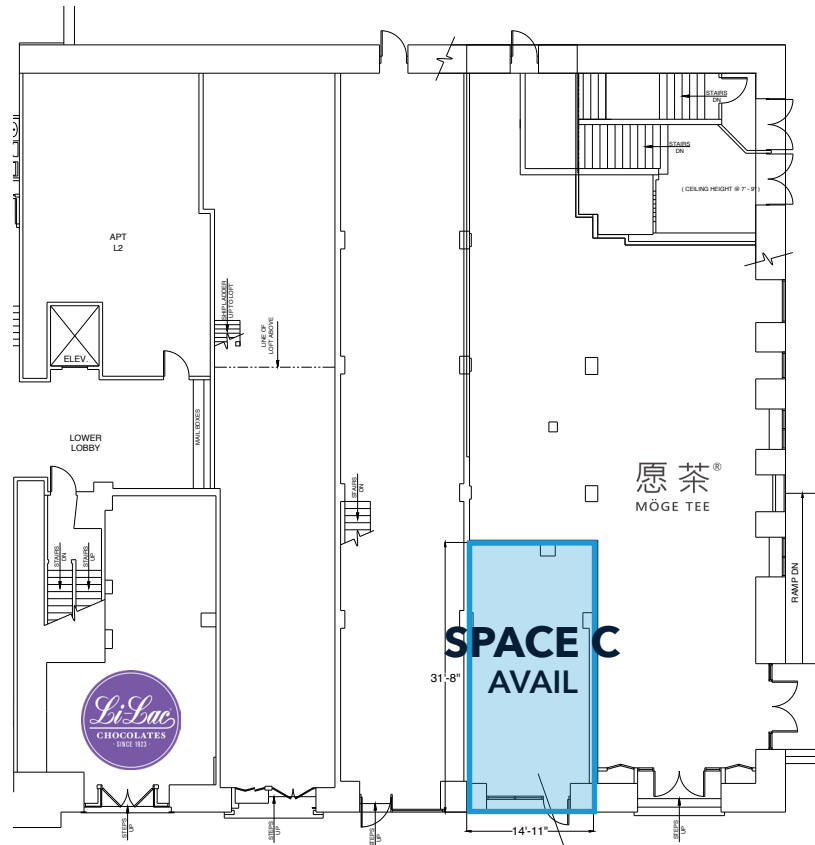

Sullivan Street

Bleecker Street

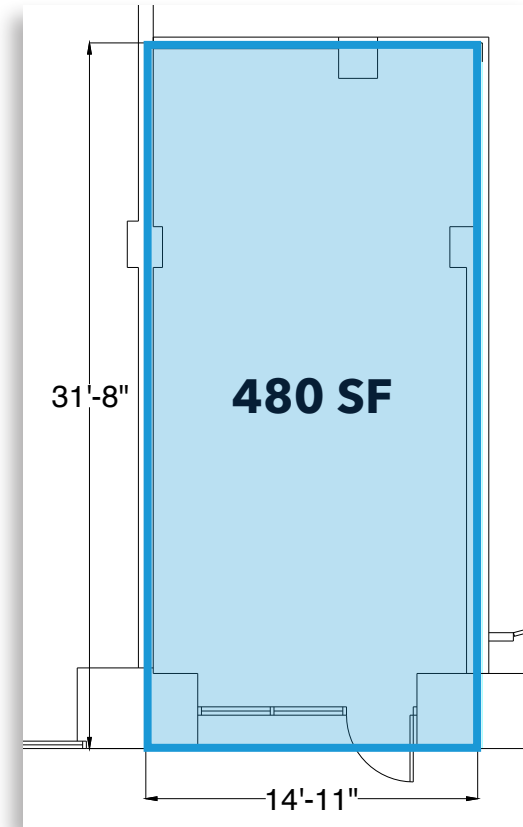

SPACE C

Ground Floor **480 SF**

Frontage **12'**

Asking Rent **Upon Request**

Possession **Immediate**

NEIGHBORS



COMMENTS

Most Uses Considered
Newly renovated ground floor
retail

Heavy daytime & evening
population

Gas: No
200 Amp Electric
Plumbing: Yes
Ceiling Height: 16'
Venting: None

As exclusive leasing agents, we are pleased to offer the following prime space for lease:

162-164-166 BLEECKER STREET BETWEEN SULLIVAN STREET & THOMPSON STREET



PRIME GREENWICH VILLAGE RETAIL

FOR MORE INFORMATION CONTACT

Mark Kapnick
Executive Managing Director & Principal
mkapnick@lee-associates.com
212.776.1230

Morris Dweck
Director
mdweck@lee-associates.com
212.776.1246