

611 MADISON AVENUE

SOUTHEAST CORNER OF MADISON AVENUE & 58TH STREET



FOR MORE INFORMATION, PLEASE CONTACT:

PETER BRAUS

D 212.776.1203

pbraus@lee-associates.com

MORRIS DWECK

D 212.776.1246

mdweck@lee-associates.com

ANNIE SQUIER

D 646.723.4719

asquier@lee-associates.com

611 MADISON AVENUE

SOUTHEAST CORNER OF MADISON AVENUE & 58TH STREET



SPACE

240 SF Ground Floor

FRONTAGE

Approx. 30'

CEILING HEIGHTS

9' 3"

POSSESSION

Arranged

RENT

Upon Request

NOTES

- Boutique opportunity at the epicenter of New York's most luxurious shopping corridor
- Sublease through Feb 2028
- Currently DECIEM
- All dry uses considered

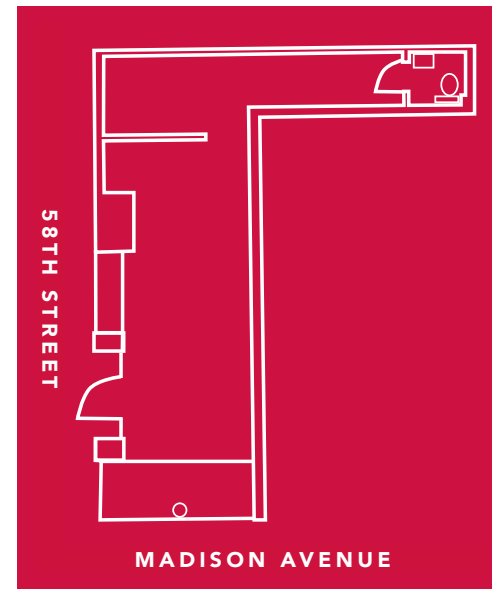

FOR MORE INFORMATION, PLEASE CONTACT:

611 MADISON AVENUE

SOUTHEAST CORNER OF MADISON AVENUE & 58TH STREET

NEIGHBORHOOD STATS

Residential Population
15,947

Median Household Income
\$194,566

2022 Transit Neighborhood Ridership
46,677,468 riders annually

N R W Q 4 5 6 F B M D

Visitors Per Year to Central Park
42 million+

Visitors to Rockefeller Center during Winter Season
800,000 daily

Hotel Rooms
8,613

Office Tenants
3,741

60TH STREET	VALENTINO TOD'S MONCLER CÉLINE	MARC JACOBS Baccarat SUIT SUPPLY MONTBLANC
59TH STREET	BALENCIAGA	GIVENCHY
58TH STREET	CHASE CANALI	ETON Santoni FRATELLI ROSSETTI
57TH STREET	CHANEL Dior TIFFANY & CO. BUCHERER	611 MADISON AVENUE [[Wolford]] BEN SOLEIMANI FENDI Christoffe
56TH STREET	Bonhams	BREITLING VACHERON CONSTANTIN REBAG OLIVER PEOPLES

FOR MORE INFORMATION, PLEASE CONTACT:



PETER BRAUS
D 212.776.1203
pbraus@lee-associates.com

MORRIS DWECK
D 212.776.1246
mdweck@lee-associates.com

ANNIE SQUIER
D 646.723.4719
asquier@lee-associates.com